

Hermoso |

Post Top
Light

60W/90W
Power & CCT Adjustable



This cutting-edge LED Post Top Light is a beacon of innovation in energy-efficient lighting solutions. Engineered with precision and style, this luminaire combines state-of-the-art LED technology with a sleek design, ensuring superior performance and aesthetics. It's not only illuminates spaces with brilliant, uniform light but also significantly reduces energy consumption and operational costs. With its durable construction and advanced features, this post top light is an ideal choice for enhancing outdoor environments, from parks to pathways. Transform your surroundings with it, where sustainability meets sophistication.

STANDARDS/CERTIFICATES

- ◀ IEC 60598-1
- ◀ IEC 60598-2-3
- ◀ EN 55015
- ◀ EN 61547
- ◀ EN61000-3-2
- ◀ EN 61000-3-3
- ◀ EN IEC 62598-2-1
- ◀ EN 62471
- ◀ EN IEC 62031
- ◀ EN 62493



WITH KERA FYRM DIFFUSER PLATE



Product data

General Information

Light source engine type	LED
Driver included	Sosen
Lifetime	L70B10 >102000hr Light maintenance assessments to TM-21 based on LM-80 data.
Warranty	5 years

Operating and Electrical

Input Voltage / Frequency	100-277V, 50~60Hz
Electrical class	Class I
Power factor (at full load)	>0.95
Surge Protection	Luminaire surge protection level until 6 kV differential mode and 6 kV common mode(10KV/20KV SPD for option)

Controls and Dimming

Power adjustable	1: 100%-80%-60% 2: 100%-70%-50%
CCT Tunnable	1: 2200K-3000K-4000K 2: 3000K-4000K-5000K 3: 4000K-5000K-6000K
Cables	3x1.0mm ²

Light Technical

Luminous Efficacy (rated) (Nom)	150lm/w
Wattage	60W/90W
Luminous Flux	9000/13500LM
Upward light output ratio (ULR)	Between 0.00% and 0.35%
General ingress protection	Luminaire: IP66 (EN IEC 60598-1)
Protection against impacts	IK08 (IEC 62262)
Color rendering index (CRI)	>70
LED colour temperature	3000K/4000K/5000K/5700K/6500K
Optical cover type	Symmetric
Photometric distributions	90°
Total harmonic distortion	<8% (220Vac/50Hz, Full load, 25 °C)
McAdam ellipse	≤5
Ambient temperature range	-40~+45 °C

Mechanical and Housing

Housing Material	ADC12
Optic material	PC/PMMA
Housing Color	RAL9004

Maintenance and Assembly

Installation methods	Installation of lamp post
Accessories	Remote controller

WITH LENS



Product data

General Information

Light source engine type	LED
Driver included	Sosen
Lifetime	L70B10 >102000hr Light maintenance assessments to TM-21 based on LM-80 data.
Warranty	5 years

Operating and Electrical

Input Voltage / Frequency	100-277V, 50~60Hz
Electrical class	Class I
Power factor (at full load)	>0.95
Surge Protection	Luminaire surge protection level until 6 kV differential mode and 6 kV common mode(10KV/20KV SPD for option)

Controls and Dimming

Power adjustable	1: 100%-80%-60% 2: 100%-70%-50%
CCT Tunnable	1: 2200K-3000K-4000K 2: 3000K-4000K-5000K 3: 4000K-5000K-6000K
Cables	3x1.0mm ²

Light Technical

Luminous Efficacy (rated) (Nom)	150~160lm/w
Wattage	60W/90W
Luminous Flux	9600/13500LM
Upward light output ratio (ULR)	Between 0.00% and 0.35%
General ingress protection	Luminaire: IP66 (EN IEC 60598-1)
Protection against impacts	IK08 (IEC 62262)
Color rendering index (CRI)	>70
LED colour temperature	3000K/4000K/5000K/5700K/6500K
Optical cover type	Asymmetric
Photometric distributions	TypeII / TypeIII / TypeIV
Total harmonic distortion	<8% (220Vac/50Hz, Full load, 25 °C)
McAdam ellipse	≤5
Ambient temperature range	-40~+45 °C

Mechanical and Housing

Housing Material	ADC12
Optic material	PC/PMMA
Housing Color	RAL9004

Maintenance and Assembly

Installation methods	Installation of lamp post
Accessories	Remote controller

Accessory



Remote controller

Light distribution angle

Optical options: **90°**

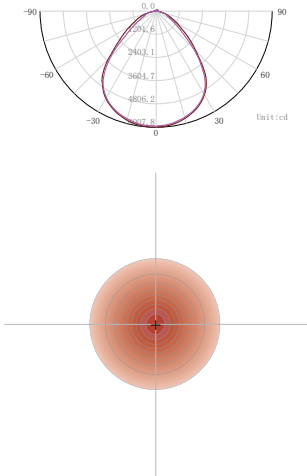

Light distribution angle

Optical options: **TypeII**

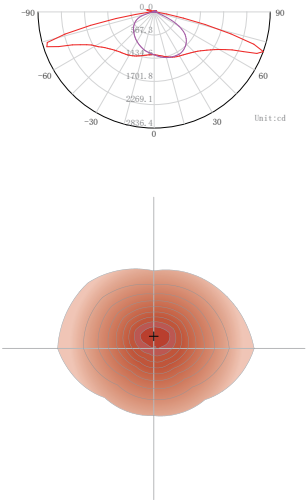

Optical options: **TypeIII**

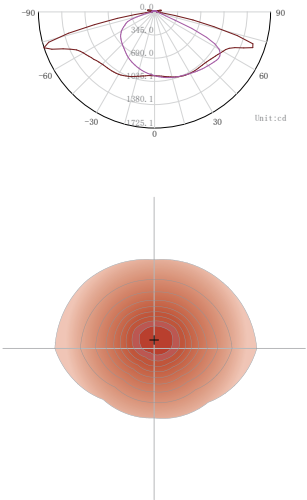

Optical options: **IV**

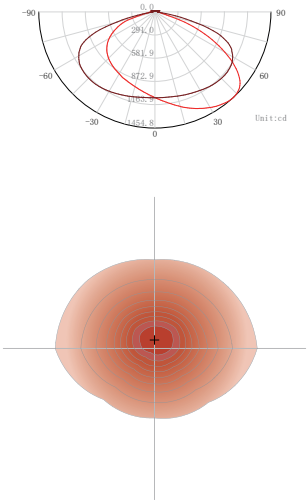

Package

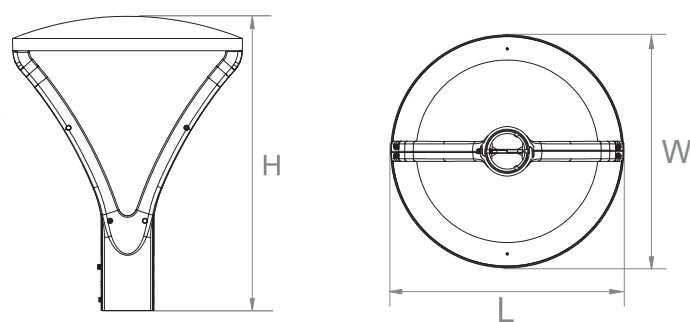

Model	Dimension(mm)			Outer Carton(mm)			QTY/ CTN	NW(kg)	GW(kg)
	L	W	H	L	W	H			
LN060HE1H-PS/LN060HEGH-PS	422	422	539	520	470	227	1	5.70	6.80
LN090HE1H-PS/LN090HEGH-PS	422	422	539	520	470	227	1	5.70	6.80



Container	Model	QTY/Container
20GP	60W	350PCS
20GP	90W	350PCS



Container	Model	QTY/Container
40GP	60W	720PCS
40GP	90W	720PCS

Application

